

78

YAMAHA

MODEL GUIDE

PRESENTATION DE MODELE

LB3/LB3M/LB3-80



YAMAHA

1017561 TH

NOTE: SPECIFICATIONS AND OTHER TECHNICAL DATA GIVEN IN THIS MODEL GUIDE MAY BE SUBJECT TO CHANGE WITHOUT PRIOR NOTICE.

Model name, I.D. number, country, starting engine No. and remarks

Model name	I.D. No.	Country	Starting engine No.	Remarks		
				Clutch	Speed limited	Foot pedal
LB3M	1V3	Germany	1V3-000101~	A	Yes	Without
↑	1V4	Belgium	1V4-000101~	↑	↑	↑
↑	1V5	Austria	1V5-000101~	↑	↑	↑
↑	1V6	France	1V6-000101~	↑	↑	With
LB3	1M8	Switzerland	1M8-100101~	H	No	Without
LB3-80	1M9	Germany	1M9-000101~	A	↑	↑

Note: A: Centrifugal automatic clutch
H: Manual clutch

A. Aims of the product

To meet the growing demand for mini-leisure motorbikes, it is redesigned so that machine safety and utility are enhanced.

B. Features (Sales and service points)

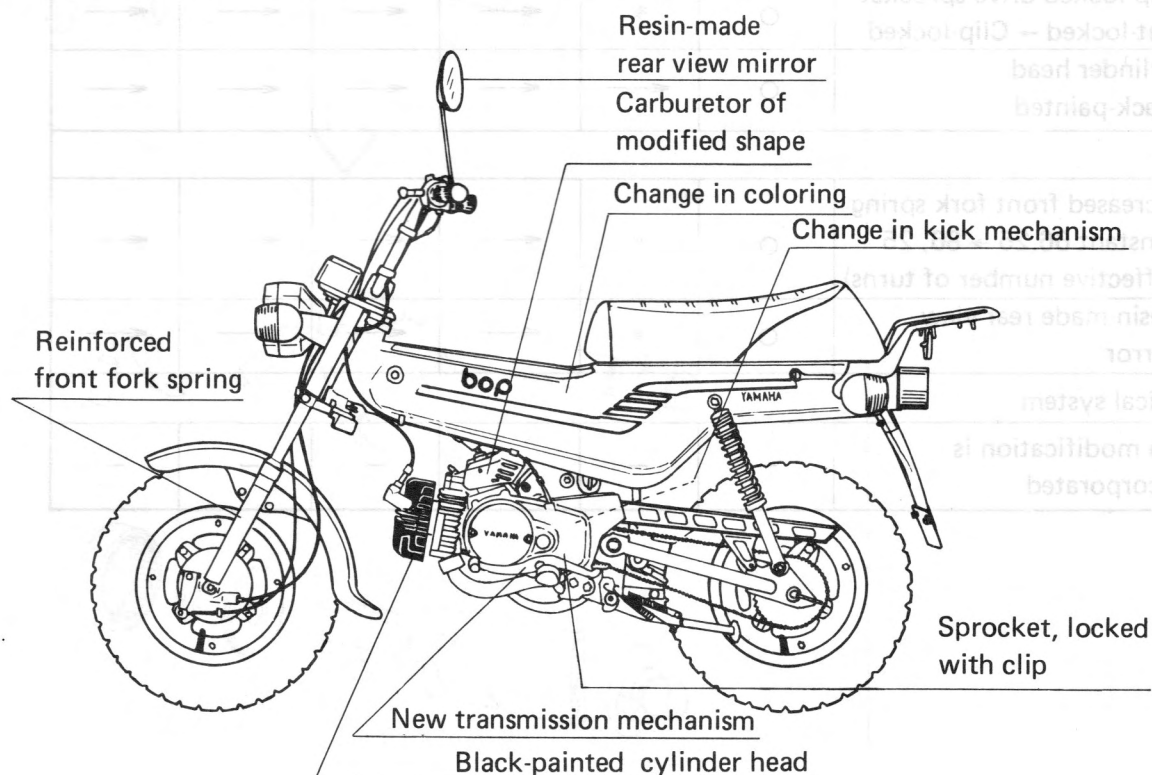

LB3
LB-3M
LB3-80

C. Summary of differences from the 1977 model

Note: — Not incorporated

○ Incorporated in
1978 model

* Incorporated in
1977 model

Item	Model name	LB3-80	LB3	LB3-M	←	←	←
	Type	1M9	1M8	1V3	1V4	1V5	1V6
	Destination	Germany	Switzer-land	Germany	Belgium	Austria	France
Engine							
1) Change in shape of carburetor VM14SC → VM14SS		—	○	←	←	←	←
2) Modified transmission 3 shift forks → 2 shift forks		○	*	←	←	←	←
3) Change in kick mechanism Ratchet type → Bendix type		○	*	←	←	←	←
4) Clip-locked drive sprocket Nut-locked → Clip-locked		○	*	←	←	←	←
5) Cylinder head Black-painted		○	←	←	←	←	←
Frame							
1) Increased front fork spring constant 66.25 → 86, 25 (Effective number of turns)		○	*	←	←	←	←
2) Resin-made rear view mirror		○	*	←	←	←	←
Electrical system							
No modification is incorporated		—	—	—	—	—	—

LB3
LB-3M
LB3-80

D. Differences from the 1977 model

MODIFICATION

REMARKS

[Engine section]

1. Carburetor

- a) VM14SS (Mikuni) → VM14SC (Mikuni)
- b) Change in shape of air cleaner case

- c) Change in air cleaner joint
- d) Change in shape of manifold

2. Shifter

The number for shift forks has been decreased from 3 to 2.

Standardization
Due to change the carburetor



Standardization

Original type

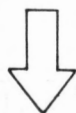
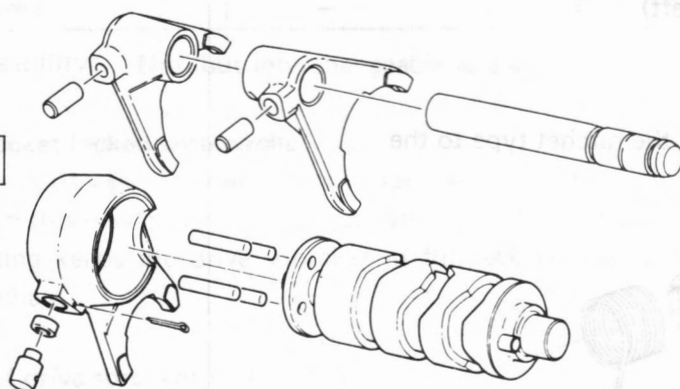

New type

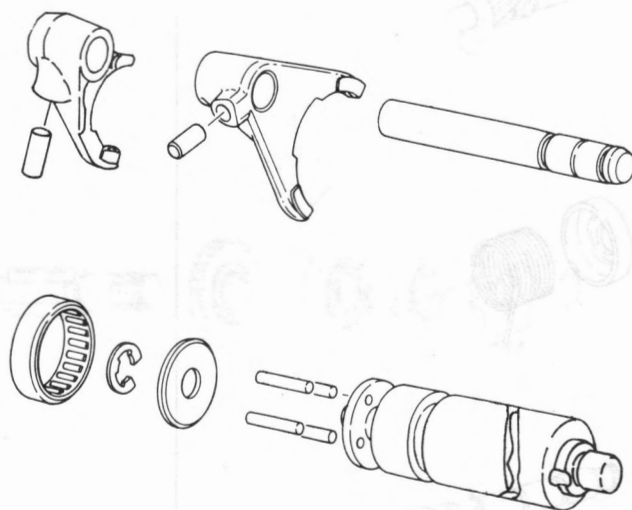

LB3-80
LB-3M
LB3

MODIFICATION

REMARKS

List of modified parts for the shifter.

No.	Part name	Old part No.	New part No.	Remarks
1	Shift cam	517-18541-00	1W7-18541-00	Cam grooves: reduced from 3 to 2
2	Shift fork 1	296-18511-00	1W7-18511-01	
3	Shift fork 2	296-18512-01	1W7-18512-01	
4	Shift fork 3	296-18513-01	Discontinued	
5	Pin	90249-05041	←	
6	Cam follower roller	136-18551-00	←	
7	Cotter pin	91401-25017	←	

Interchangeability: Not, but interchangeable as a set with the abovementioned parts, modified transmission parts, and crankcase (left)

3. Kick starter

The kick starter has been changed from the ratchet type to the Bendix type.

Original type

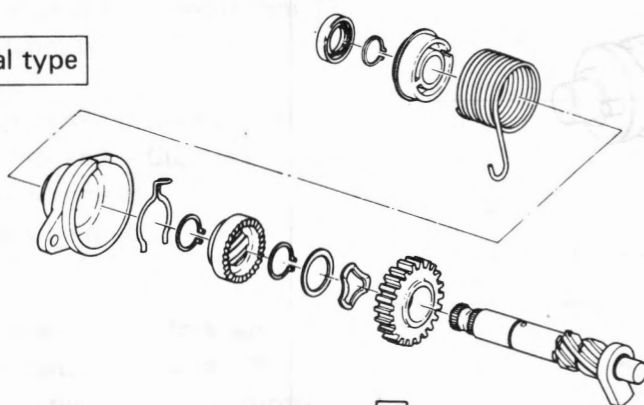

New type

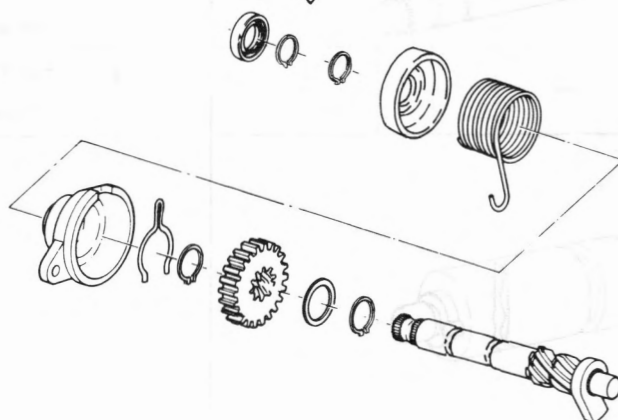

LB3-80
LB-3M
LB3-80

REMARKS	MODIFICATION	REMARKS
Kick starter		
List of modified parts (Ratchet type to Bendix type)		

No.	Part name	Old part No.	New part No.	Remarks
1	Kick axle ass'y	517-15660-01	1W7-15660-10	Helical splines
2	Kick gear	296-15641-00	1W7-15641-00	Helical splines in bore
3	Wave washer	90206-19027	Discontinued	
4	Shim	296-15644-00	↑	
5	Circlip	93410-19015	93410-20009	S19 → S20
6	Ratchet wheel	296-15671-00	Discontinued	
7	Kick clip	90468-26046	1W7-15687-00	Shape of bend is changed
8	Kick spring guide	296-15664-00	1W7-15676-00	Aluminum → Hard nylon
9	Kick spring cover	132-15676-01	1W7-15676-00	Cast zinc → Sheet iron
10	Plate washer	—	90201-20266	Newly added

○ Interchangeability: Not, but interchangeable as a set of the abovelisted parts

4. Drive sprocket locked with circlip

On the previous year's model, the drive sprocket is locked with nut, but on this new model, it is locked with circlip. This floating type locking keeps the drive sprocket in full-face contact with the drive chain.

Locking of drive sprocket with circlip

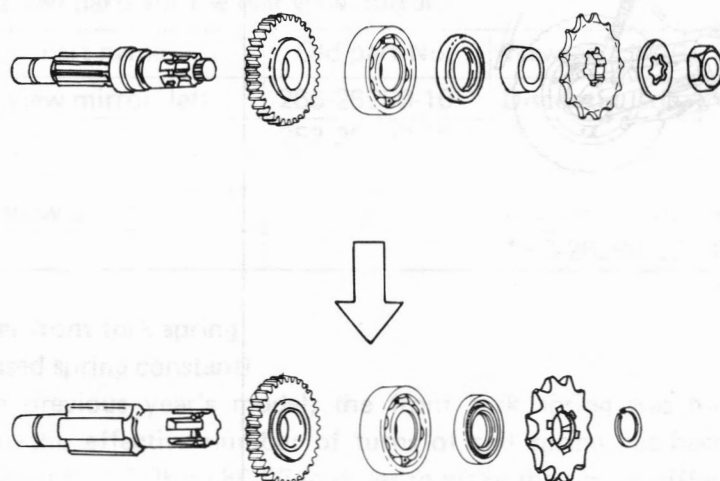

LB3
LB-3M
LB3-80

REMARKS	MODIFICATION	REMARKS
List of modified parts for the drive sprocket.		

No.	Part name	Old part No.	New part No.	Remarks
1	Lock nut	90179-12181	Discontinued	
2	Lock washer	90215-13019	↑	
3	Circlip	—	93440-20043	Newly added
4	Distance collar	90387-17228	Discontinued	
5	Oil seal	93102-26042	↑	
6	"	—	93102-20143	Newly added
7	Bearing	93306-30305	Discontinued	
8	"	—	93306-20401	Newly added
9	Drive axle comp.	441-17420-00	Discontinued	
10	Drive axle	—	517-17421-00	Newly added

○ Interchangeability Not, but interchangeable as a set of the above-listed parts.

5. Black-painted engine

The engine is black-painted to give an impressive look to the machine.

Better appearance

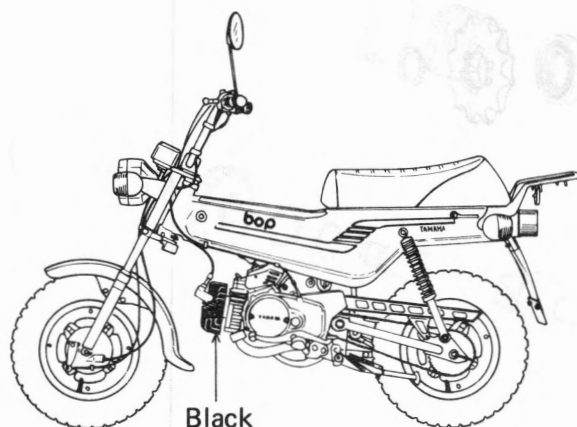
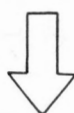
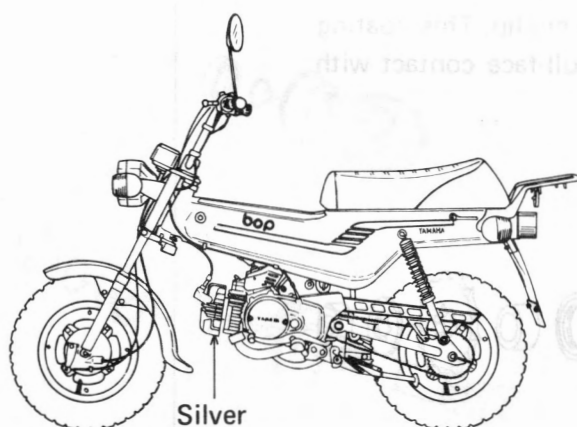

LB3
LB-3M
LB3-80

MODIFICATION

REMARKS

List of modified parts for the cylinder head.

No.	Part name	Old part No.	New part No.	Remarks
1	Cylinder head	439-11111-00	296-11111-01	for the 1V3 ~ 1V6
2	"	517-11111-00	1M8-11111-00	for the 1M8
3	"	527-11111-00	1M9-11111-00	for the 1M9

[Frame section]

1. Resin-made rear view mirror

The rear view mirror is made of a resin so it is lighter in weight and gives a better look.

Better design

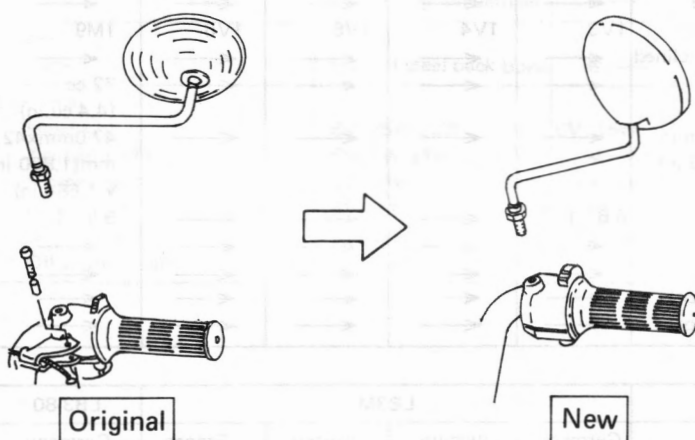

List of modified parts for the rear view mirror.

No.	Part name	Old part No.	New part No.	Remarks
1	Rear view mirror, left	266-26290-10	Discontinued	
	"	257-26290-20	↑	
	"	407-26290-50	↑	
2	Rear view mirror, right	—	1Y0-26290-10	Belgium, Austria
	"	—	1Y0-26290-50	Germany

2. Stronger front fork spring

(Increased spring constant)

On the previous year's model, the front fork spring was too soft, so the effective number of turns of coil spring has been increased from 66.25 to 86.25 in order to make the spring stiffer. As a result, the front forks will not travel down too far when the brake is applied.

Part Name	Old part No.	New part No.	Remarks
Front fork ass'y	1V3-23100-00	1V3-23100-01	for the 1V3
"	1M3-23100-00	1M8-23100-00	for the 1V4, 1V5, 1M8, 1M9
"	1M9-23100-F0	1M9-23100-F1	for the 1V6

Interchangeability: Not individually, but interchangeable as a front fork assembly.

LB3-80
LB-3M
LB3-80

Item	LB3	LB3M				LB3-80
	Switzerland	Germany	Belgium	Austria	France	Germany
Dimension:						
Overall length	1,680 mm (66.1 in)	←	←	←	←	←
Overall width	670 mm (26.3 in)	650 mm (25.6 in)	←	←	←	←
Overall height	965 mm (38.0 in)	980 mm (38.5 in)	965 mm (38.0 in)	←	←	←
Wheelbase	1,055 mm (41.5 in)	←	←	←	←	←
Minimum road clearance	155 mm (6.10 in)	13.5 mm (5.3 in)	←	←	←	155 mm (6.10 in)
Weight:						
Net	73 kg (160 lb)	75 kg (165 lb)	←	←	←	76 kg (168 lb)
Performance:						
Climbing capacity	20.5°	21°	18°	21°	←	22°
Minimum turning radius	1,700 mm (67.0 in)	←	←	←	←	←
Engine:						
Type	2-stroke, gasoline	←	←	←	←	←
Model	1M8	1V3	1V4	1V5	1V6	1M9
Cylinder	Single, forward inclined	←	←	←	←	←
Displacement	49 cc (3.0 cu.in)	←	←	←	←	72 cc (4.4 cu.in)
Bore and stroke	40.0 mm x 39.7 mm (1.57 in) (1.56 in)	←	←	←	←	47.0mmx42.0 mm(1.850 in x 1.654 in)
Compression ratio	6.4 : 1	6.6 : 1	←	←	←	5.8 : 1
Starting system	Kick starter	←	←	←	←	←
Ignition system	Magneto	←	←	←	←	←
Gasoline tank capacity	3.4 lit (3.0 IMP. qt)	←	←	←	←	←
Oil tank capacity	1.3 lit (1.1 IMP. qt)	←	←	←	←	←

Item	LB3	LB3M				LB3-80
	Switzerland	Germany	Belgium	Austria	France	Germany
Lubrication system	Separate lubrication (Yamaha Autolube)	←	←	←	←	←
Battery capacity	6V, 4AH	←	←	←	←	←
Generator system	Flywheel magneto	←	←	←	←	←
Spark plug	BP-6HS	←	←	←	←	B-6HS
Carburetor	VM14SC	←	←	←	←	VM16SC
Air cleaner	Oiled, foam rubber	←	←	←	←	←
Carburetor:						
Type and manufacturer	VM14SC, MIKUNI	←	←	←	←	VM16SC MIKUNI
I.D. mark	1V700	1V500	1V300	1V500	←	1M600
Main jet (M.J.)	#120	#115	#105	#115	←	#100
Air jet (A.J.)	2.5	←	←	←	←	←
Jet needle (J.N.)	3G9-4	3E2-2	←	←	←	3G9-3
Needle jet (N.J.)	E8	E6	←	←	←	←
Cutaway (C.A.)	3.0	2.5	←	←	←	3.0
Pilot jet (G.S.)	#15	←	←	←	←	#20
Air screw (turns out)(A.S.)	1-1/2	1-1/4	←	←	←	←
Starter jet (G.S.)	#25	←	←	←	←	←
Float level	23.0 ± 1	←	←	←	←	24.0 ± 1
Idling engine speed	1,350 ± 100 rpm	←	←	←	←	←

Part Name	Old part No.	New part No.	Remarks
Front fork ass'y	1V3-23100-00	1V3-23100-01 for the 1V3	
	1M3-23100-00	1M8-23100-00 for the 1V4, 1V5, 1M8, 1M9	
	1M9-23100-00	1M9-23100-01 for the 1V6	

Item	LB3		LB3M				LB3-80
	Switzerland	Germany	Belgium	Austria	France	Germany	
Transmission:							
Secondary reduction ratio	33/13 (2.538)	36/13 (2.769)	42/13 (3.231)	36/13 (2.769)	35/13 (2.692)	36/14 (2.577)	
Gear ratio:							
1st	39/12 (3.250)	←	←	←	←	←	
2nd	34/17 (2.000)	29/16 (1.813)	←	←	←	←	
3rd	30/21 (1.429)	24/20 (1.200)	←	←	←	←	
4th	27/24 (1.125)	←	←	←	←	←	
Steering:							
Caster	27°	←	←	←	←	←	
Trail	60 mm (2.36 in)	←	←	←	←	←	
Tire size:							
Front	4.00-10-2PR	4.00-10-4PR	4.00-10-2PR	←	←	2.00-10-4PR	
Rear	4.00-10-2PR	4.00-10-4PR	←	←	←	←	
Suspension:							
Front	Telescopic fork	←	←	←	←	←	
Rear	Swing arm	←	←	←	←	←	
Shock absorber:							
Front	Coil spring, oil damper	←	←	←	←	←	
Rear	Coil spring, oil damper	←	←	←	←	←	
Frame:							
Type	Pressed steel back bone	←	←	←	←	←	
Electrical:							
Headlight	6V, 25W/25W	6V, 15W	7V,18W/18W	6V, 15W	6V, 6W	6V, 25W/25W	
Tail/stoplight	6V, 5W/21W	←	←	←	←	←	
Flasher light	6V, 21W	←	6V, 10W	6V, 8W	6V, 10W	←	
Meter light	6V, 3W	←	←	←	←	←	
Neutral light	6V, 3W	←	←	←	←	←	
Oil caution light	6V, 3W	←	←	←	←	←	

- 10 -



YAMAHA MOTOR CO.,LTD.

IWATA, JAPAN